

FlowDSA-XM™ (Research Use Only)

Advanced Crossmatch Testing

Key Benefits

Selective Detection

- Crossmatch testing that distinguishes leukocyte antibodies from autoantibodies
- Selectively detect any bound IgG on the cell surface

Familiar Workflow

- Combines traditional flow cytometry cellular crossmatch with microbeads technology
- Compatible with most basic flow cytometers (1-laser)
- Lymphocytes from fresh or frozen sources (peripheral blood, lymph nodes, or spleen)



Crossmatch Testing with Selective Detection

The FlowDSA-XM is a flow cytometry based crossmatch assay optimized for the detection of leukocyte antibodies. Combining traditional flow cytometry cellular crossmatch testing with the specificity of microbeads technology, the FlowDSA-XM selectively distinguishes leukocyte antibodies from autoantibodies.

After incubating lymphocytes with human serum, any bound IgG on the cell surface is tagged with PE labeled anti-human IgG. FlowDSA-XM Capture Beads bind selectively with the resulting antibody/antigen/PE-anti-IgG complex and the fluorescent intensity is measured to indicate the relative amount of leukocyte antibody present in the serum.

FlowDSA-XM – Advanced Crossmatch Testing

Principle

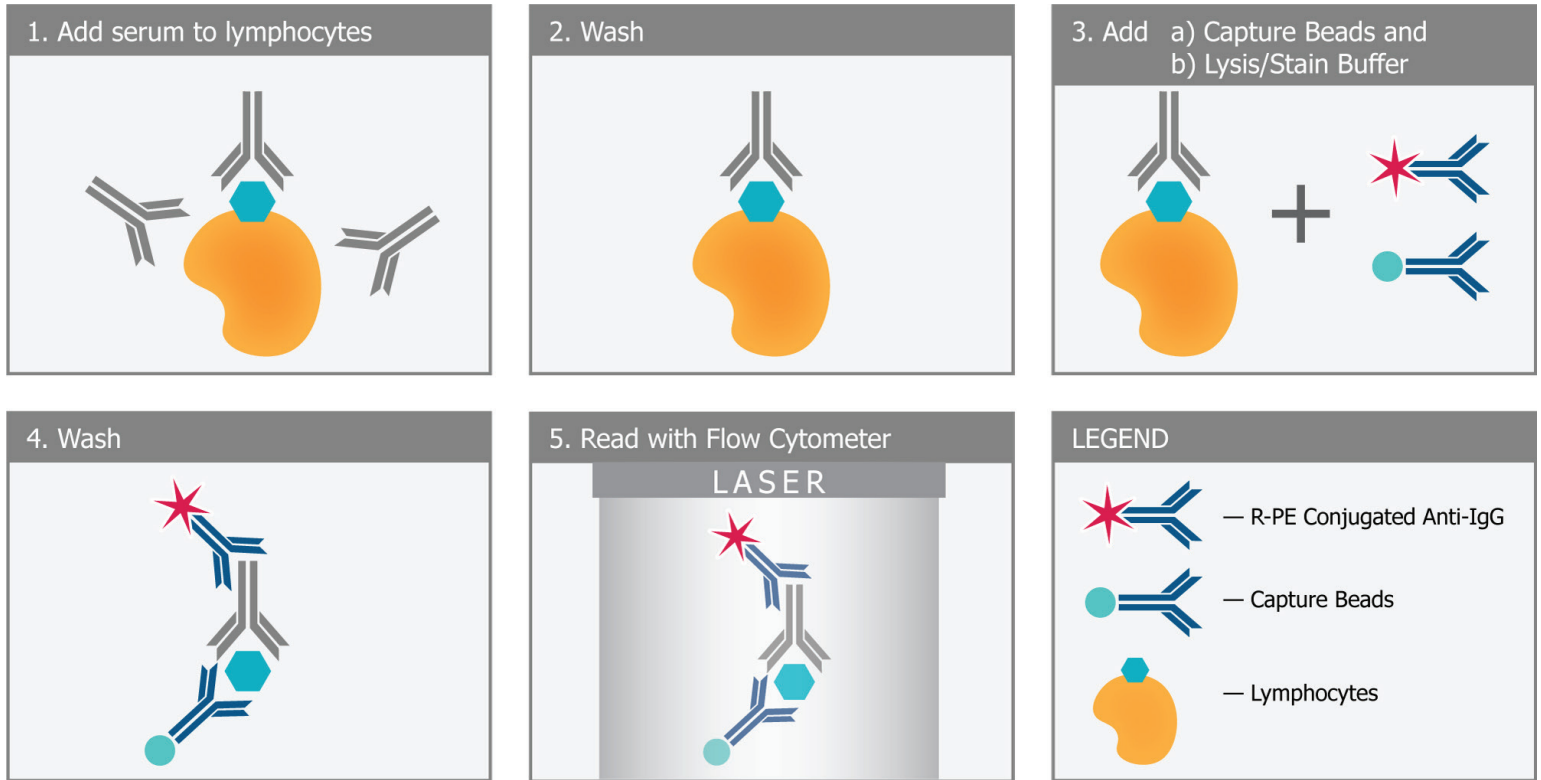

Ordering Information

| Product | Tests | Cat. No. |
|------------|----------|----------|
| FlowDSA-XM | 25 tests | FLDSA |

For Research Use Only. Not for use in diagnostic procedures.

This product is not intended for the diagnosis, prevention, or treatment of disease or to aid in clinical decision making process. This product is not cleared or approved for use by the US FDA nor is this product CE marked.

Find out more at onelambda.com

© 2017 Thermo Fisher Scientific Inc. All rights reserved. All trademarks are the property of Thermo Fisher Scientific and its subsidiaries. Specifications, terms and pricing are subject to change. Not all products are available in all countries. Please consult your local sales representative for details.

 **ONE LAMBDA**
A Thermo Fisher Scientific Brand



MKT-PS-FDSA-000 | May 2017 | REV 0



Rafer INNOVACIÓN
TECNOLÓGICA
PARA LABORATORIO

www.rafer.es

| | | | | | | | | |
|--|---|--|---|--|---|---|---|---|
| Barcelona ☎ 93 645 50 28 ✉ barcelona@rafer.es | Bilbao ☎ 94 499 85 80 ✉ bilbao@rafer.es | La Coruña ☎ 981 93 89 26 ✉ galicia@rafer.es | Madrid ☎ 91 365 15 70 ✉ madrid@rafer.es | Málaga ☎ 639 359 792 ✉ malaga@rafer.es | Sevilla ☎ 954 369 334 ✉ sevilla@rafer.es | Valencia ☎ 96 340 48 00 ✉ levante@rafer.es | Zaragoza ☎ 976 23 74 00 ✉ rafer@rafer.es | Lisboa ☎ 21 154 19 98 ✉ lisboa@rafer.es |
|--|---|--|---|--|---|---|---|---|