



## 92000 MA•GEL•IN UNIVERSAL CAST-YOUR-OWN SYSTEM

The NEW **Ma•GEL•In** is truly a versatile protein system designed to accommodate today's researcher. This system will allow you to cast your own gels using the 10 cm x 10 cm glass plates and easy-to-use casting system, or if you prefer to use 8 cm x 10 cm precast gels, the **Ma•GEL•In** will accommodate those as well. This versatility comes from the specially designed (patent pending) gel capture system that allows plates in a 10 cm x 10 cm format or cast-your-own glass plates in a 10 cm x 10 cm format.

**Casting your own gels:** The #920000 comes with three sets of glass plates and a 2-place casting system for casting your own gels. The 2-place casting system #921000 has a very small footprint (10 cm x 15 cm), utilizing minimal space on the counter. The glass plates are held together using neoprene spacers.

Once assembled, the glass sandwich is placed in the casting system, and the lid is mounted to the top of the casting system. The gel can now be

cast through the opening in the lid. Once the gel has polymerized, the glass sandwiches can be removed from the casting system, placed in the gel capture unit, and set into the buffer tank. Quick and simple!

**Pre-Cast gels:** Using the same gel capture unit, 8 cm x 10 cm precast polyacrylamide gels can be inserted, locked in place, and set into the buffer tank. The **Ma•GEL•In** will accommodate various brands of pre-cast gel. The #920000 is an all-inclusive, easy-to-use, protein electrophoresis system designed for years of continuous use.

**"Discover what Ma•GEL•In can do for you!"**

The tank holds a minimum of 350 ml of buffer. For longer runs, the tank can be filled to a maximum of 850 ml. A stir bar can be placed in the tank to recirculate the buffer to keep the ionic concentration constant.

The tank includes a patented vented lid to further reduce heat buildup during the gel run.

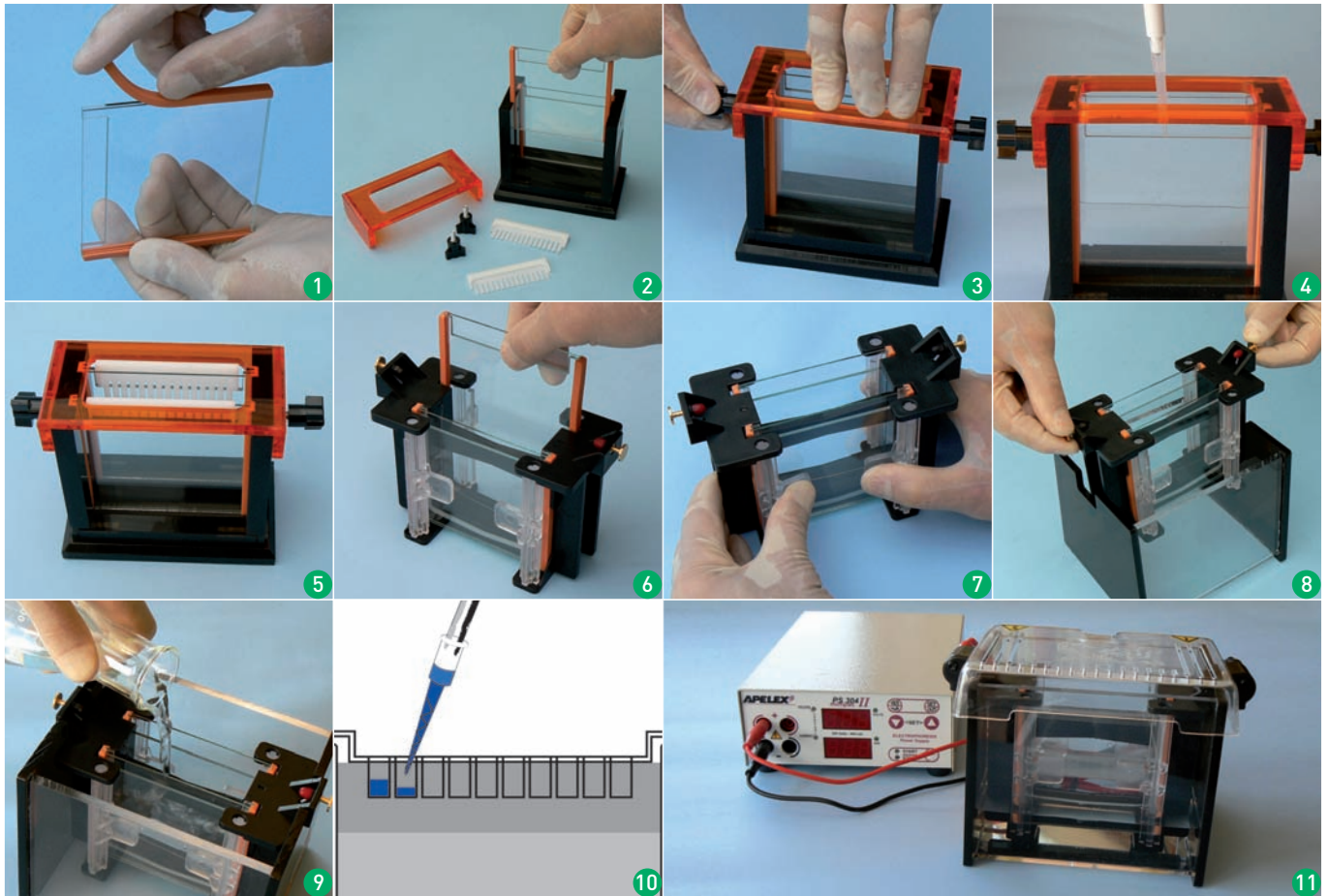

## SET UP

- 1 • Create glass plate sandwich with spacers and glass slides.
- 2 • Place glass sandwich into casting system-notched plates to inside.
- 3 • secure lid by pressing down and inserting locking knobs.
- 4 • Add gel through opening in lid.
- 5 • Carefully remove combs.
- 6 • Insert gel plates in gel capture device per instructions.
- 7 • Turn cams inward to secure gel plates.
- 8 • Place gel capture device in tank-note keyed inserts.
- 9 • Pour appropriate amount of buffer.
- 10 • Load the samples in the wells.
- 11 • Initiate desired program.

## TECHNICAL SPECIFICATIONS - CONSTRUCTION

• Inner gel support	Molded ABS
• Clamp assemblies	Molded polycarbonate
• Buffer chamber	3/8" acrylic
• Gaskets	Extruded silicone
• Shipping weight	2.2 Kg
• Overall size	17 cm (L) x 17 cm (W) x 18 cm (H)
• Gel size	8 cm (L) x 10 cm (W) or 10 cm (L) x 10 cm (W)

The 92000 comes with a patented vented lid.  
Patent #5779,869.

## ORDERING INFORMATION

**92000** **Ma•GEL•In Universal Protein Cast-Your-Own System.**  
Includes: center support, buffer tank, vented lid, casting system, three inner and three outer glass plates, two sets of 0.8 mm side spacers, two 0.8 mm x 15 tooth combs, power cords, and manual.

	Description	Well Width	Sample Volume Per mm Gel
92030	0.8 mm x 10 tooth	5.86 mm	28.13 µl
92031	0.8 mm x 12 tooth	4.22 mm	20.26 µl
92032	0.8 mm x 15 tooth	3.38 mm	16.22 µl
92033	0.8 mm x 1 sample	70 mm	336 µl

## SUGGESTED POWER SUPPLY

**PS 304**      300 Volts      400 mA      Cat. No. 160500

## ORDERING INFORMATION

Description	
50500	Replacement Power Cords
92010	Inner Glass Plate, Set of 5 (Notched)
92020	Outer Glass Plate, Set of 5
92025	0.8 Spacer Set (2 Spacers)
92040	Replacement Tank
92050	Replacement Gel Capture Device
92060	Replacement Lid
92070	Replacement Gaskets, casting System, 2 Each
92071	Replacement Thumb Screws, 2 Each
92072	Replacement Tank Connector Kit
92100	Protein Casting System, 2 Place
92200	Protein Casting System, 8 Place
92500	Western Transfer Module